

100 Olde Towne Road

Vestavia Hills, AL 35216

FOR LEASE



±3,400 SF Available on First Floor in the Heart of Vestavia

Features

- Two spaces available on the first floor:
 - ±1,050 SF & ±2,350 SF (Can be combined for a total of ±3,400 SF)
- Excellent location on Hwy 31, just minutes from I-65
- Neighboring Mark's Outdoors, Diplomat Deli, Tazikis, Romeo's Sporting Goods and many others
- High traffic area with a traffic count on Hwy 31 of over 31,000 VPD
- Ample Parking
- 1st Floor easy access
- \$17.50 Full Service net of janitorial

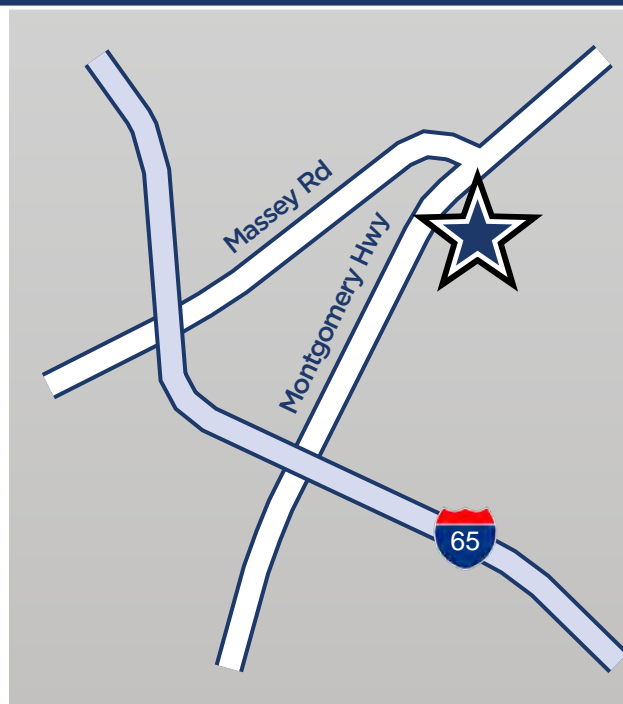

Sorrell Chew

205.380.3329 • sorrell@hsccommercial.com



100 Olde Towne Road

Vestavia Hills, AL 35216

FOR LEASE

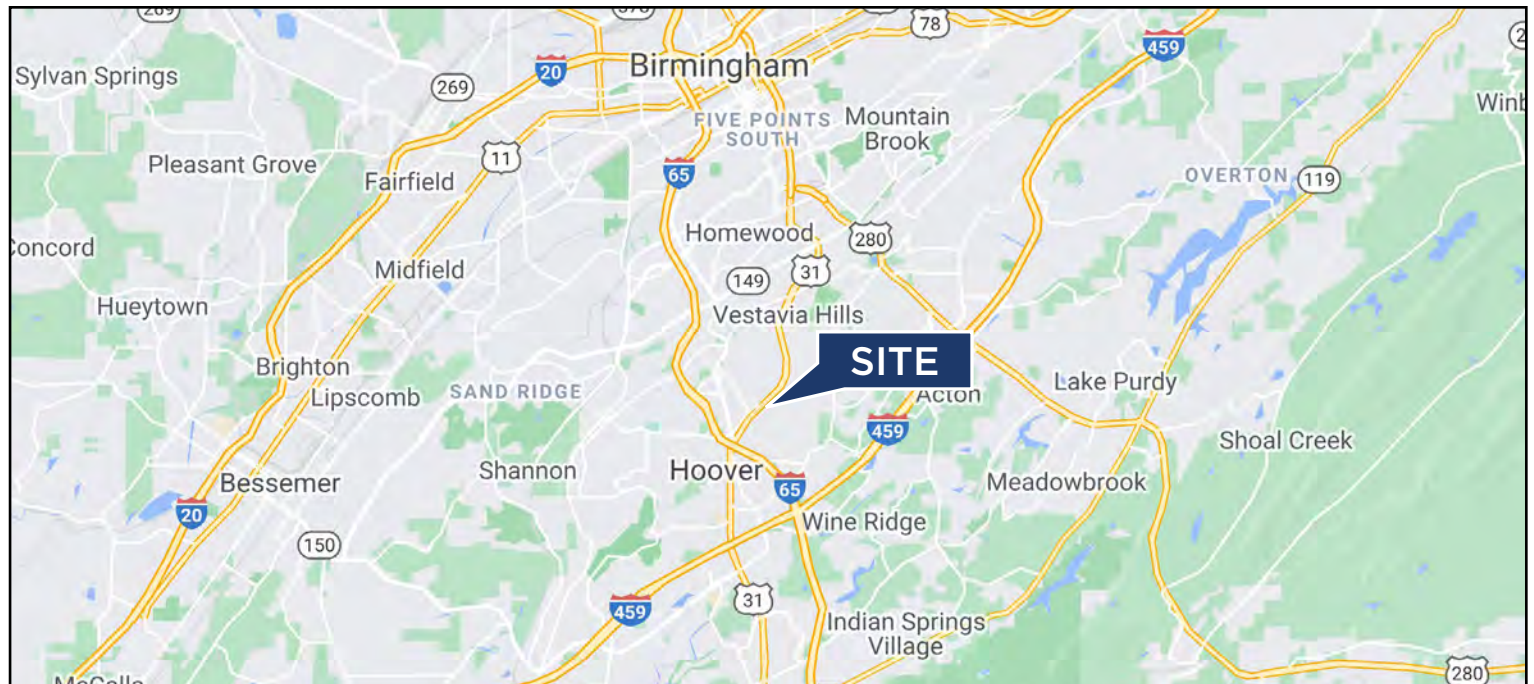

Sorrell Chew

205.380.3329 • sorrell@hsccommercial.com



100 Olde Towne Road

Vestavia Hills, AL 35216

FOR LEASE

Floor Plan

±2,350 SF

±1,050 SF

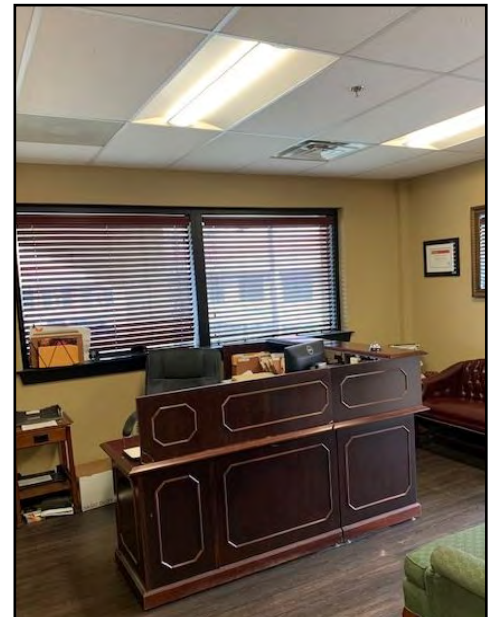
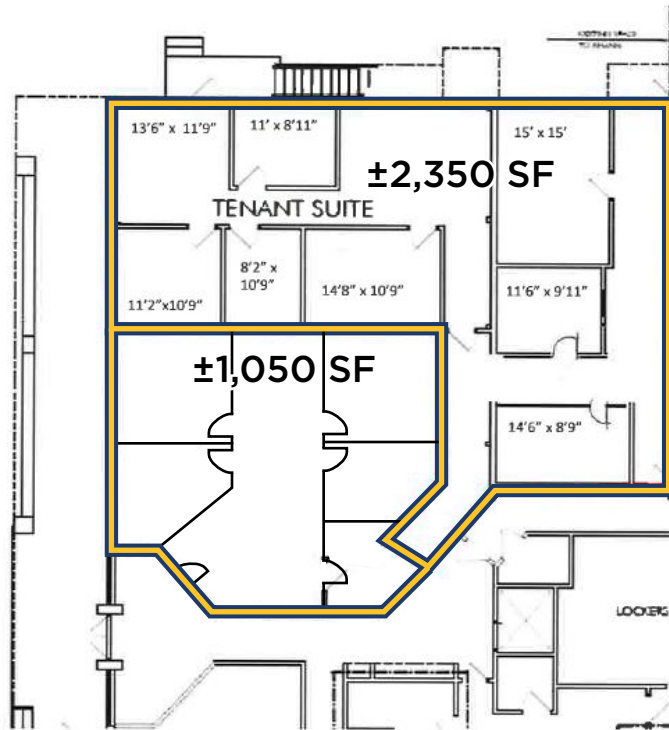

Sorrell Chew

205.380.3329 • sorrell@hsccommercial.com

